



Orenco PRELOS



CAPITAL SEPTIC SUPPLY

Orenco
WATER
PROTECTING THE WORLD'S WATER



Orenco Prelos 1000 Processor

Orenco's Prelos 1000 Processor provides complete, integrated storage, filtration, and pumping of wastewater for on-lot portions of Prelos Sewer systems and other pressurized liquid-only sewers or dispersal systems.

General

The Prelos Processor is the core of the Prelos Sewer System: an innovative technology based on 40 years of proven sewer solutions. The tank stores and passively treats solid waste, while the patent-pending pump vault and filter separate and pump liquid effluent.*

All Prelos 1000 Processors install as a unit, to reduce errors. The 30in (750mm) diameter access riser provides easy access to the tank interior, and the passively self-cleaning filter can be removed without removing the pump vault, pump, or discharge assembly, simplifying O&M and keeping related costs down.

* Tank covered under United States Patent #10,392,281

PRELOS1000-18, PRELOS1000-24, PRELOS1000-30, PRELOS1000-36, PRELOS1000-48, PRELOS1000-60

Product Code Diagram

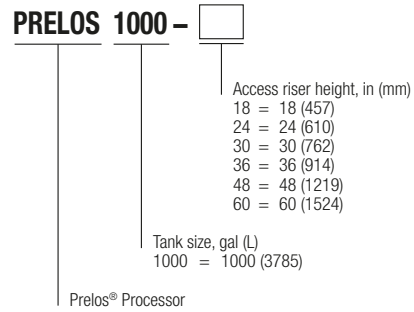

The Prelos 1000 Processor offers complete, integrated storage and pumping of wastewater in a simple, effective package.

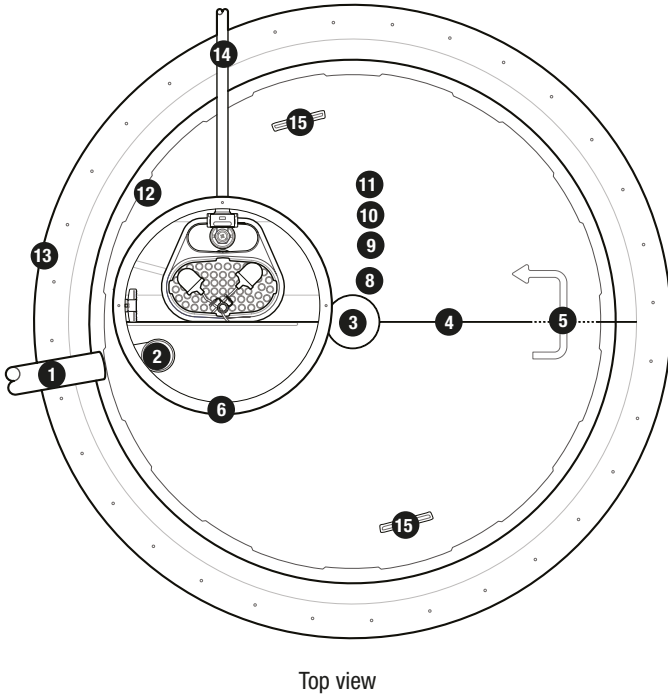
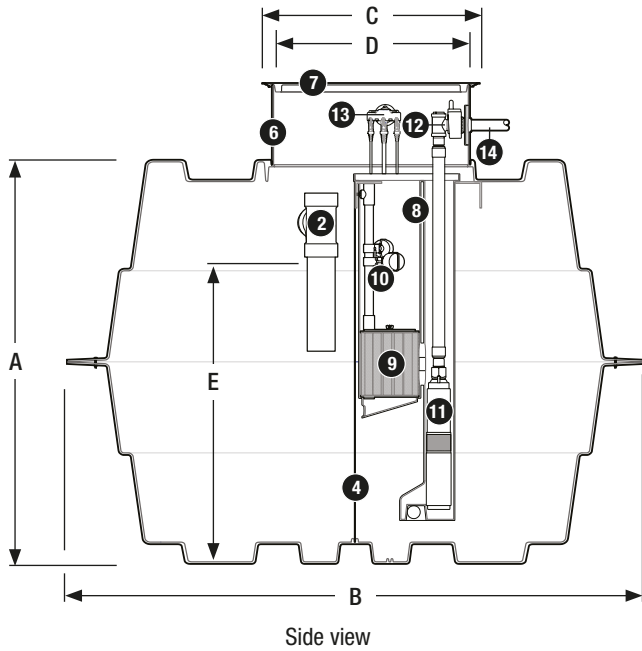

- | | | |
|------------------------------|---------------------------|------------------------|
| 1. Inlet | 6. Access riser | 11. Pump |
| 2. Inlet tee | 7. Access lid | 12. Discharge assembly |
| 3. Support column | 8. Pump vault | 13. ClickTight™ |
| 4. Baffle wall (full-length) | 9. Biotube® filter | 14. Discharge |
| 5. Baffle pass-through | 10. Float switch assembly | 15. Lifting bracket |

Tank, Riser, and Lid

The Prelos 1000 Processor's meander-style tank has a patented design for superior performance. It's tough, impact resistant, and light enough to install with small equipment. The single 30in (750mm) access riser and access lid are designed to provide strong, secure access to components inside of the Prelos 1000 Processor.

Materials of Construction

Access lid	Fiber-reinforced polymer (FRP), structural foam
Access lid hardware	Stainless steel
Access riser	FRP
Inlet and inlet tee	ABS
Baffle wall	ABS
Support column	PVC, ABS
Tank body	DCPD

Dimensions

A	Tank height, in (mm)	61 (1549)
B	Tank outside diameter, in (mm)	96 (2438)
C	Lid outside diameter, in (mm)	33 (838)
D	Riser inside diameter, in (mm)	29.5 (749)
E	Depth, nominal operating volume, in (mm)	48 (1219)
	Tank nominal operating volume, gal (L)	1000 (3785)
	Tank total volume, gal (L)	1220 (4618)
	Average volume at operating depth, gal/in (L/mm)	20 (3)
	Prelos Processor weight, nominal, lbs (kg)	550-640 (250-290)

Applications

Orengo's watertight M-series molded dicyclopentadiene (DCPD) tank* is optimized for multiple uses, including septic tanks and dosing tanks in onsite wastewater collection and treatment systems (commercial and residential), as well as in community-wide, liquid-only sewer systems. It collects and digests organic matter, providing primary wastewater treatment by reducing BOD and TSS by 65% and 70% or better, respectively.**

These tanks are not tested for use with potable water.

Product Code Diagram

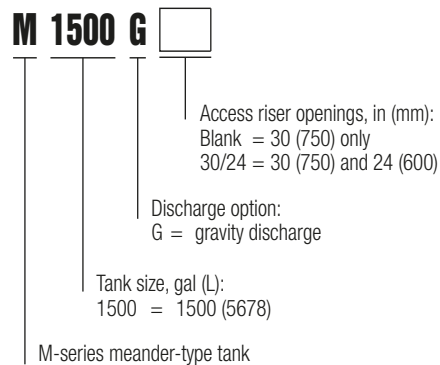

NOTE Listed by IAPMO/UPC. These tanks are not designed for use in a location that receives vehicle traffic. Placement in a traffic area requires an engineered traffic-bearing pad.

Orengo's watertight M1500G tanks are lightweight, durable, and versatile.
(Access risers and lids sold separately.)

Features

- 1500gal (5678L) meander-type tank for longer settling times and better solids retention
- Baffle wall provides two-thirds/one-third tank split
- 100% watertight design; each assembled tank is tested for watertightness before shipping
- DCPD construction for structural durability and chemical resistance
- Injection molded for unmatched consistency and quality
- Sized for transport by a light pickup or small trailer
- Lightweight enough for lifting and installation with a backhoe
- Ideal for small and tight lots
- 30in (750mm) access riser opening
- 24in (600mm) secondary access riser opening

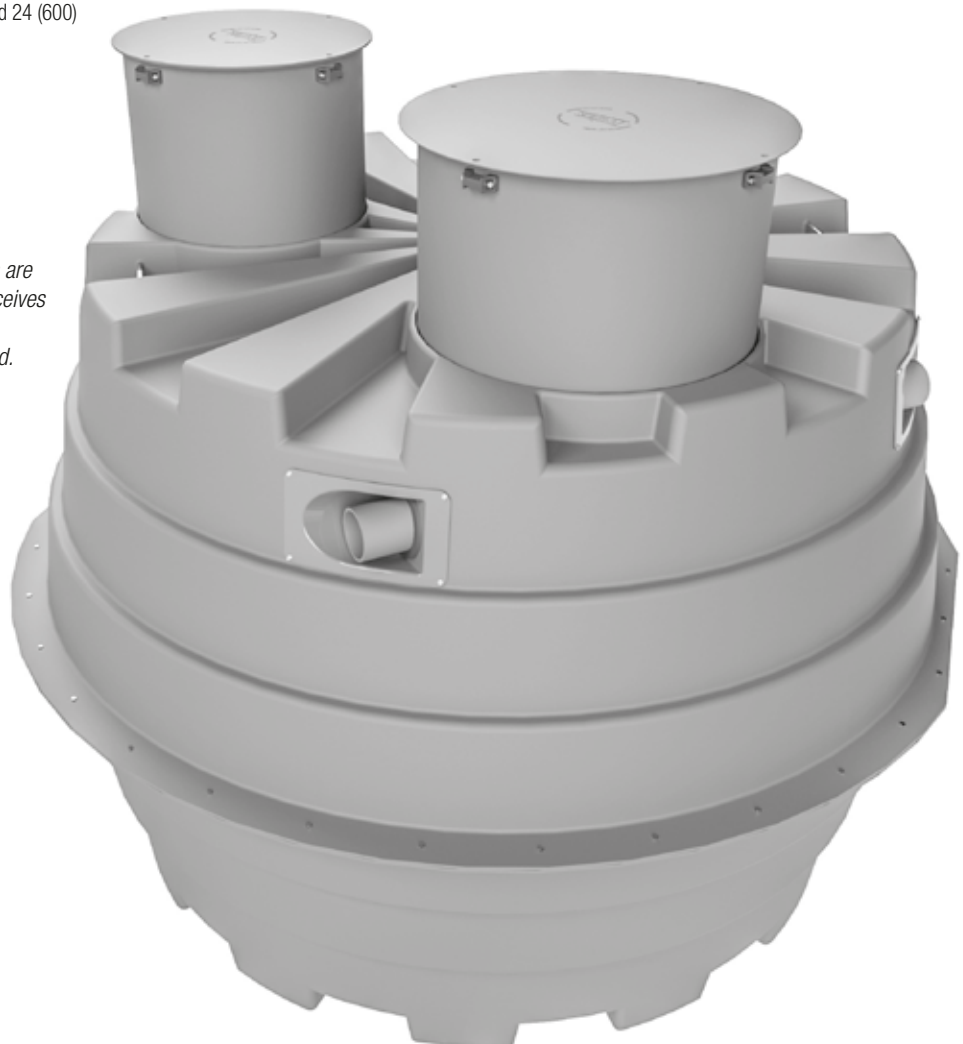

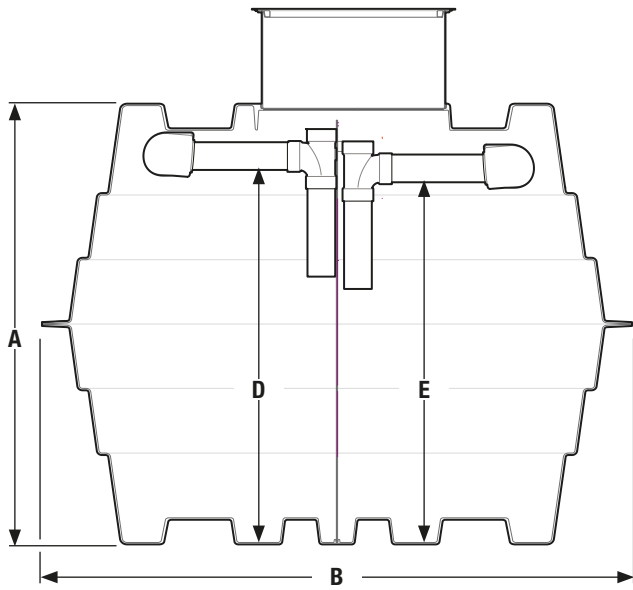

Side sectional view, M1500G (access risers and lids sold separately)

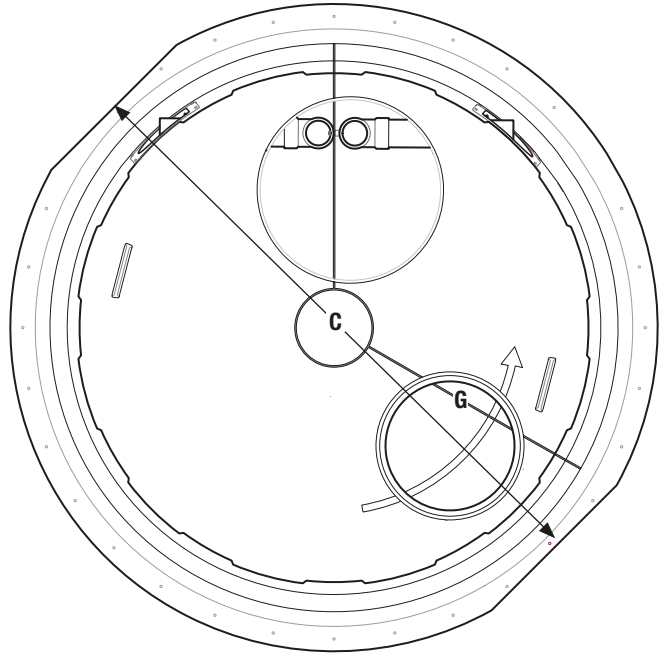

Top sectional view, M1500G

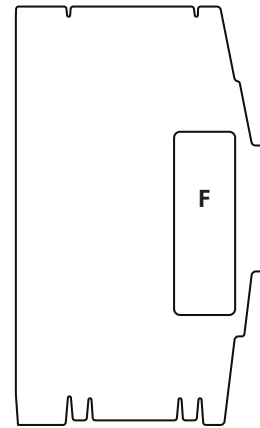

Baffle wall profile showing flow-through port

Materials of Construction

Inlet	Fiberglass, ABS
Tank body	DCPD
Support column	PVC, ABS
Baffle wall	ABS
Outlet	Fiberglass, ABS

Specifications

Tank nominal operating volume, gal (L)	1500 (5678)
Tank total volume, gal (L)	1788 (6768)
Average volume at operating depth, gal/in (L/mm)	25 (4)
Weight, nom, lbs (kg)	500 (227)
A. Tank height, in (mm)	72 (1829)
B. Tank outside diameter, in (mm)	105 (2667)
C. Tank width, flat-to-flat, in (mm)	101 (2565)
D. Invert of inlet height, in (mm)	61 (1549)
E. Invert of outlet height, in (mm)	59 (1499)
F. Flow-through port area, in ² (mm ²)	299.1 (192967)
G. Baffle wall location	



CAPITAL SEPTIC SUPPLY

Orenco[®]
W A T E R
PROTECTING THE WORLD'S WATER